

Rapid Set[®]



EISENWALL[®]

5000

1/2" Cementitious Stucco System Over Sheathing



Save Time & Money
Single coat application, finish the same day

Ultra-Versatility
Use any finish, conventional or acrylic

Less is More
Less shrinkage, greater strength & durability

Faster Project Completion
Remove scaffolding 10 days early

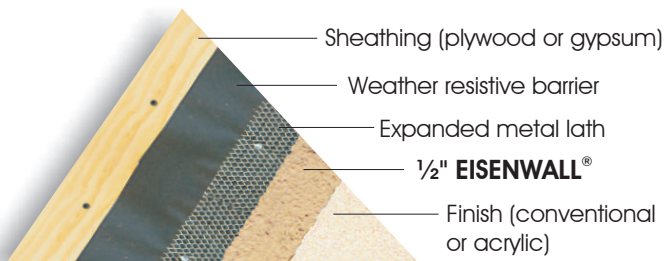

The EISENWALL[®] 5000 System

Rapid Set®

EISENWALL® 5000 1/2" Stucco System

EISENWALL® 5000 1/2" Stucco System

Product Name:
Rapid Set®
EISENWALL® 5000
Premium Stucco System

Manufacturer:
CTS Cement Manufacturing Corp.
11065 Knott Ave. Suite A
Cypress, CA 90630
1 (800) 929-3030
Web: www.rapidset.com
E-mail: info@rapidset.com

Description:
The Rapid Set® EISENWALL® 5000 Premium Stucco System consists of a 1/2 basecoat of Rapid Set® EISENWALL® Cement Plaster reinforced with metal lath, finished with 1/8 of synthetic or conventional stucco finish. EISENWALL® Cement Plaster is a proprietary blend of premium cement mixed with a high quality graded plaster sand. The system is applied to substrates of plywood or gypsum sheathing and installed on exterior walls of wood or steel framing construction, as well as concrete or concrete masonry walls. Reference ICBO ER-5528.

Materials:
Rapid Set® EISENWALL® Cement is a low shrinkage, high performance plastic cement complying with UBC Standard 25-1 and ASTM C-1328. Sand must be clean and free from deleterious amounts of loam, clay, silt, soluble salts and organic matter. Sampling and testing must comply with ASTM C-144. See CTS specification for sand gradation limits. Metal lath must be self-furring expanded metal fabricated from copper bearing steel, with weight of 3.4 pounds per square yard, galvanized. Sheathing must be either plywood

sheathing of minimum 3/8 thickness, or 1/2 thick gypsum sheathing board complying with ASTM C79-92. The weather resistive barrier shall be a minimum two layers of Grade D building paper complying with UBC 24-1. All corner reinforcement/aid, casing beads, foundation weep screed, and control/expansion joints shall be 1/2 galvanized steel.

Application:
Mix according to CTS guidelines. Apply the basecoat by hand troweling or gun application, in one coat, to 1/2 thickness. Use sufficient pressure and mechanical force to embed metal lath, fill all spaces behind metal lath, and provide a mechanical key with metal lath. The basecoat shall be brought out to grounds, straightened to a true surface, and finished with sufficient texture to assure adequate bond with the finish coat. Float the surface as soon as possible to avoid overworking and weakening the material. As soon as floating is completed, begin moist curing of the basecoat for a minimum of one hour or until the basecoat is sufficiently hydrated this will be achieved when the surface cannot be easily scratched by a nail.

The finish coat may be conventional or acrylic based finish. Apply the finish coat to 1/8 thickness, per manufacturers guidelines/ instructions. The basecoat may require light water misting to ensure even suction. Apply the finish coat evenly and consistently in order to achieve uniformity in color and texture.

The applicator/contractor shall be experienced with the application of the



EISENWALL® Premium Stucco System, and possess an Approved Applicator Certificate stating such. Alternatively, the applicator shall obtain a letter from CTS stating temporary approval and shall have a CTS representative on-site for application.

Limited Warranty: CTS Cement Manufacturing Corporation warrants its materials to be of good quality, and, at its sole option, within one year of sale, will replace defective materials or refund the purchase price thereof and such replacement or refund shall be the limit of CTS's responsibility. Except for the foregoing, all warranties, express or implied including merchantability and fitness for a particular purpose are excluded. CTS shall not be liable for any consequential, incidental, or special damages arising directly or indirectly from the use of the material.

Caution: Rapid Set® Eisenwall® contains cementitious materials and may cause irritation to lungs, eyes, and skin. Avoid contact. Use only in adequate ventilation. Do not breathe dust. Wet mixture may cause burns. Wear suitable gloves, eye protection and protective clothing. In case of skin contact, wash thoroughly with soap and water. In case of eye contact, flush immediately and repeatedly with large quantities of water and get prompt medical attention. In case of difficulty breathing, remove person to fresh air. If difficulty breathing persists, seek medical attention.